

French Lick Conference & Banquet Space

First Floor	Total Square Feet	Dimensions	Ceiling Height	Theatre	Classroom	Chevron	Banquet Rd 8	Banquet Rd 10	Reception	Conference	Conference Dbl	Hollow Square	U-Shape
Erwin	787	35' x 23'	10'	63e/96b	24e/30b		24	30	74	16e/24b	22e/24b	28e/34b	20e/30b
Dickason	787	35' x 23'	10'	63e/96b	24e/30b		24	30	74	16e/24b	22e/24b	28e/34b	20e/30b
Kruetzing	588	28' x 21'	10'	63e/96b	24e/32b		24	30	74	14e/18b	20e/22b	20e/28b	16e/22b
Fairbanks	644	28' x 23'	10'	63e/96b	24e/32b		24	30	74	14e/18b	20e/22b	20e/28b	16e/22b
Taggart	2,012	49' x 42'	11'	218	48e/64b	48e/64b	72	80	218	22e/26b	28e/36b	40e/54b	30e/40b
Taggart I	921	49' x 19'	11'	86	24e/32b	24e/32b	24	40	86	18e/22b	24e/30b	30e/34b	22e/28b
Taggart II	1,091	49' x 23'	11'	124	24e/32b	24e/32b	32	40	124	18e/22b	24e/30b	30e/34b	22e/28b
Murdock	1,221	37' x 33'	10'	70e/80b	30e/40b	30e/40b	40	50	122	18e/24b	24e/30b	36e/40b	27e/30b
Hickman	1,221	37' x 33'	10'	70e/80b	30e/40b	30e/40b	40	50	122	18e/24b	24e/30b	36e/40b	27e/30b
Clifton Ballroom	6,752	93' x 73'	11'6"	646	240e/280b	200e/240b	240	300	646				
Clifton I	3,358	46' x 73'	11'6"	353	120e/140b	120e/140b	96	120	353	36e/48b	40e/58b	54e/72b	45e/60b
Clifton II	3,394	47' x 73'	11'6"	353	120e/140b	120e/140b	96	120	353	36e/48b	40e/58b	50e/76b	45e/60b
Mezzanine													
Monon Room	1,346	58' x 17'	8'6"							15			
Habig Room	1,814	34' x 54'	9'	125	42	30	64	80	182	48	48	50	40
Sport Center	31,624	118' x 268'											

All sets are based on ergonomic conference chairs with the exception of banquet and reception sets. Calculations are conservative to provide maximum comfort and are based on 2 people per 6ft. table and 3 people per 8ft. table. (e) - ergonomic chairs (b) - banquet chairs

- Clifton Foyer sq. footage 2,848
- The tennis court area of the Sports Center will hold 200, 10'x10' booths with 8' aisles and perimeters.

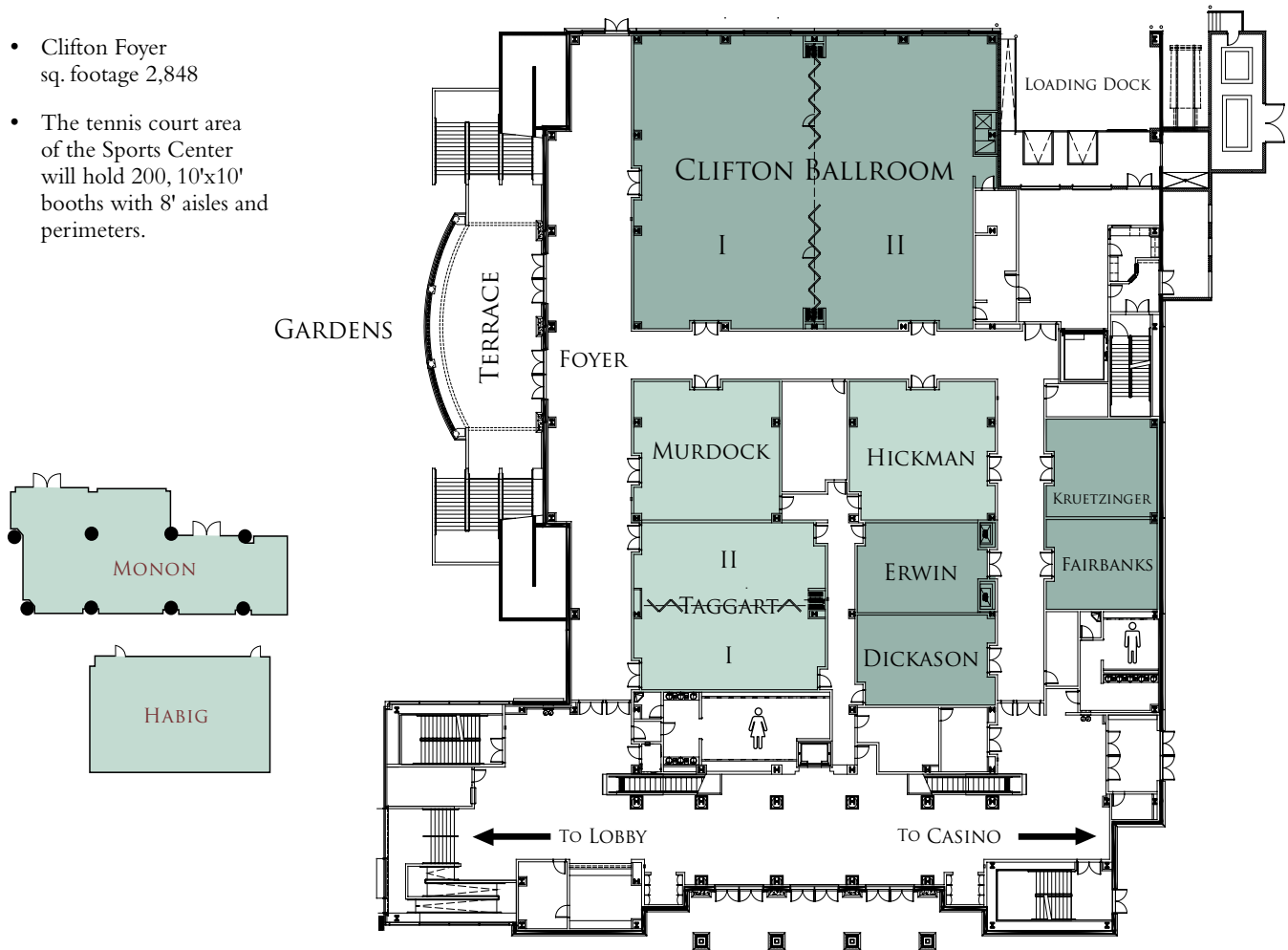

French Lick Conference & Banquet Space

Second Floor	Total Square Feet	Dimensions	Ceiling Height	Theatre	Classroom	Chevron	Banquet Rd 8	Banquet Rd 10	Reception	Conference	Conference Dbl	Hollow Square	U-Shape
Windsor Ballroom	12,727	89'x 143'	18'	1568	600	540	616	810	1482				
Windsor I	3,827	89' x 43'	18'	400	180	140	168	210	514	64	64	100	68
Windsor II	4,272	89' x 48'	18'	500	180	140	168	210	476	80	80	100	82
Windsor III	4,628	89' x 52'	18'	600	180	140	168	280	564	80	80	100	82
Windsor I & II	8,099	89' x 91'	18'	800	360	400	392	490	920				
Windsor II & III	8,900	89' x 100'	18'	900	540	500	424	490	1028				

All sets are based on banquet chairs. Calculations are conservative to provide maximum comfort and are based on 2 people per 6ft. table and 3 people per 8ft. table.

- Windsor Foyer sq. footage 2,688

